



SPECIFICATION SHEET 20 FT

6.1 M (20 x 11 x 10FT) Accommodation Module

A60 Accommodation offering
Safe and Comfortable living for
2- 4 persons.



Specifications:

- Certified to DNV 2.7-1 / DNV 2.7-2 / EN 12079
- Lloyd's Certification Scheme (Zone II optional)
- Airlock System – overpressurized cabins
- Combined Desk-/ Bunk Bed
- Lockers including hang-/ shelving
- En Suite Shower room
- HVAC -15° / +35° C
- Fire & Gas unit (standard PLC in CPGF)
- High quality fixtures
- Plug and Play Hook Up
- Stacking 5 high fixed by twist lock
- Manufactured in house to ISO 9001
- Modules available for hire or sale



Titan Offshore Modules NL

Tel: +31 (0) 20 820 23 38

Tel: +31 (0) 62 246 25 49

Tel: +31 (0) 65 171 77 36

info@titanmodules.com

www.titanmodules.com

Dimensions

LOA 6.10m x WOA 3.35m x HOA 3.04m

Weight

Approx. 5.200 Kg

Certification

IMO-/SOLAS A60, DNV 2.7-1 / DNV 2.7-2 / EN 120709





SPECIFICATION SHEET

Indicative Floorplan 20 FT

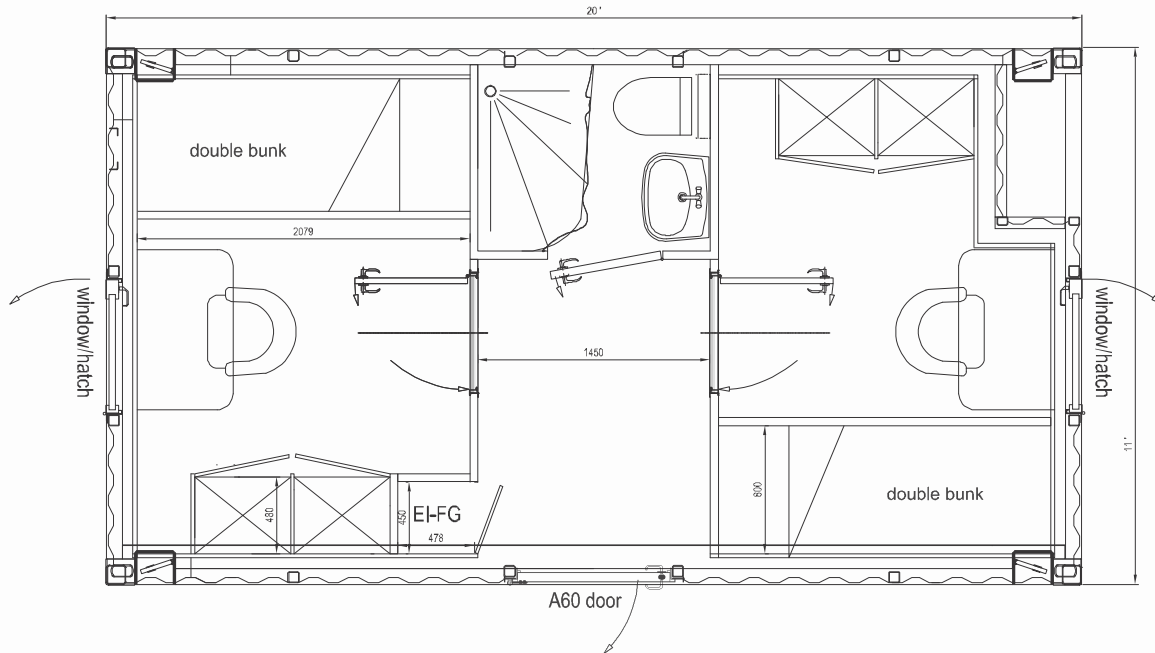

TITAN OFFSHORE MODULE 20 (20' x 11'x 10')
4 men sleeper - 5900 kg

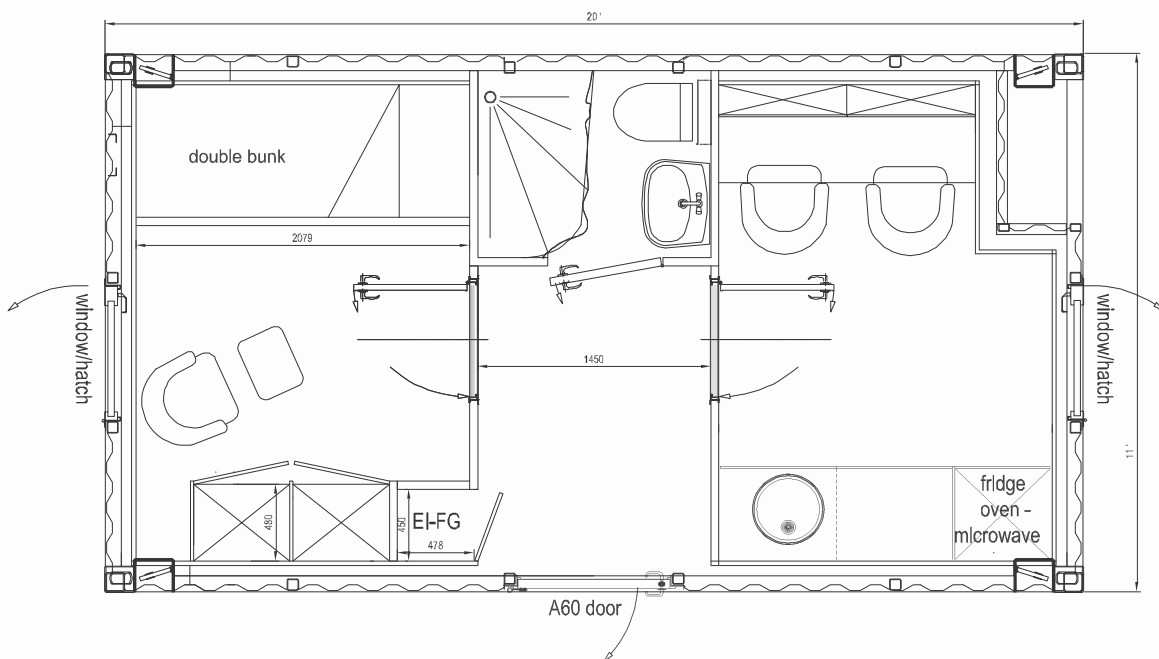

TITAN OFFSHORE MODULE 20 (20' x 11'x 10')
2 men sleeper/office/kitchenette - 6020 kg

